

# BLUE CRYSTAL GROWING INSTRUCTION GUIDE





## WARNING:

This set contains chemicals that may be harmful if misused. Read cautions on Individual containers carefully. Not to be used by children except under adult supervision.



**WARNING:** Not suitable for children under 8 years. For use under adult supervision. Contains some chemicals which present a hazard to health. Read the instructions before use, follow them and keep them for reference. Do not allow chemicals to come into contact with any part of the body, particularly the mouth and eyes. Keep small children and animals away from experiments. Keep the experimental set out of reach of children under 8 years old.

### Crystal Grow Kit - Safety Information

#### Contents list:

Chemical	Danger Symbol	H- and P-Statements	CAS No.
Ammonium dihydrogenorthophosphate (Monoammonium Phosphate)	None	None	7722-76-1

- Crystal Growing Powder – 4.35oz (125g)
- Seed Crystal Rock
- Magnifying Glass
- Wood Stir Stick
- Calcite Specimen
- Plastic Display Stand
- Instructions
- Guide
- Cardstock Display Background

#### LOCAL POISON CONTROL PHONE NUMBER

To find your local poison control center:

- In USA call 1 (800) 222-1222
- Internationally go to:

[http://www.who.int/gho/phe/chemical\\_safety/poisons\\_centres/en/](http://www.who.int/gho/phe/chemical_safety/poisons_centres/en/)

#### Advice for Supervising Adults:

- Read and follow these instructions, the safety rules and the first aid information, and keep them for reference.
- The incorrect use of chemicals can cause injury and damage to health. Only carry out those experiments which are listed in the instructions.
- This experimental set is for use only by children over 8 years.
- Because children's abilities vary so much, even



within age groups, supervising adults should exercise discretion as to which experiments are suitable and safe for them. The instructions should enable supervisors to assess any experiment to establish its suitability for a particular child.

- The supervising adult should discuss the warnings and safety information with the child or children before commencing the experiments.
  - The area surrounding the experiment should be kept clear of any obstructions and away from the storage of food. It should be well lit and ventilated and close to a water supply.
  - Substances in non-reclosable packaging should be used up (completely) during the course of one experiment, i.e. after opening the package.
  - Do not allow chemicals or the crystal growing solution to touch any object besides the inside of your heat-proof crystal growing container. Chemicals and the solution may cause damage to clothes, objects, or surfaces.
- Safety Rules:**
- Read these instructions before use, follow them and keep them for reference.
  - Keep young children and animals away from the experimental area.

- Store this experimental set and the final crystal(s) out of reach of children under 8 years of age.
- Clean all equipment after use.
- Ensure that all empty containers and/or non-reclosable packaging are disposed of properly.
- Wash hands after carrying out experiments.
- Do not eat or drink in the experimental area.
- Do not allow chemicals to come into contact with the eyes or mouth.
- Do not apply any substances or solutions to the body.
- Do not grow crystals where food or drink is handled or in bedrooms.
- Do not use any equipment which has not been supplied with the set or recommended in the instructions for use.
- Take care while handling with hot water and hot solutions.
- Ensure that during growing of the crystal the container with the liquid is out of reach of children under 8 years of age.
- Always wear eye protection.
- Dispose of contents and container in accordance with local regulations.

### First Aid

- In case of eye contact: Wash out eye with plenty of water, holding eye open if necessary. Seek immediate medical advice.
- If swallowed: Wash out mouth with water, drink some fresh water. Do not induce vomiting. Seek immediate medical advice.
- In case of inhalation: Remove person to fresh air.
- In case of skin contact and burns: Wash affected area with plenty of water for at least 10 minutes.
- In case of doubt, seek medical advice without delay. Take the chemical and its container with you.
- In case of injury always seek medical advice

## Crystal-Growing Instructions

**WARNING: Adult supervision required.**

### Crystal-Growing Steps

1. Heat 1 cup of water until boiling and select a clean, clear, heat-proof container (a pint glass is ideal) to use as a crystal-growing chamber.



2. Using the stirring stick, dissolve the crystal-growing powder into the water, stirring until no more powder will dissolve in the solution (5–10 minutes).

3. Pour the solution into the crystal-growing chamber, leaving behind any remaining undissolved crystal powder.

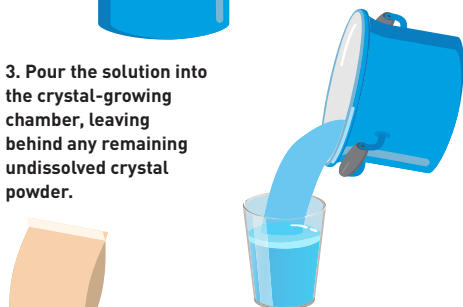

4. Put your experiment in a place where it will not be disturbed, and let it cool slowly, for 15 minutes.



5. Add the crystal seed rock (flat side down).

6. Allow the experiment to sit undisturbed for 7–10 days. You should start to see crystals forming within a day, but the longer you let the experiment sit, the larger your crystals will be.

**Tip:** Leave the crystal-growing jar uncovered so that the water will evaporate. This super-saturates the liquid even more so that the crystals will continue to grow! And remember: crystals like stable growing conditions, so try not to move your experiment while the crystal is growing.

**Note:** This is a genuine experiment and, as such, there are many variables in play that can be difficult to control. These instructions should provide optimal results, but individual results will vary. Always feel free to contact [custserv@discoverwithdrcool.com](mailto:custserv@discoverwithdrcool.com) with any questions or concerns.